

E-ZLIFT Bottom Dump Car Unloader BDCU

with Secondary Drive for 30" & 36" Wide Belts

Parts List & Schematic

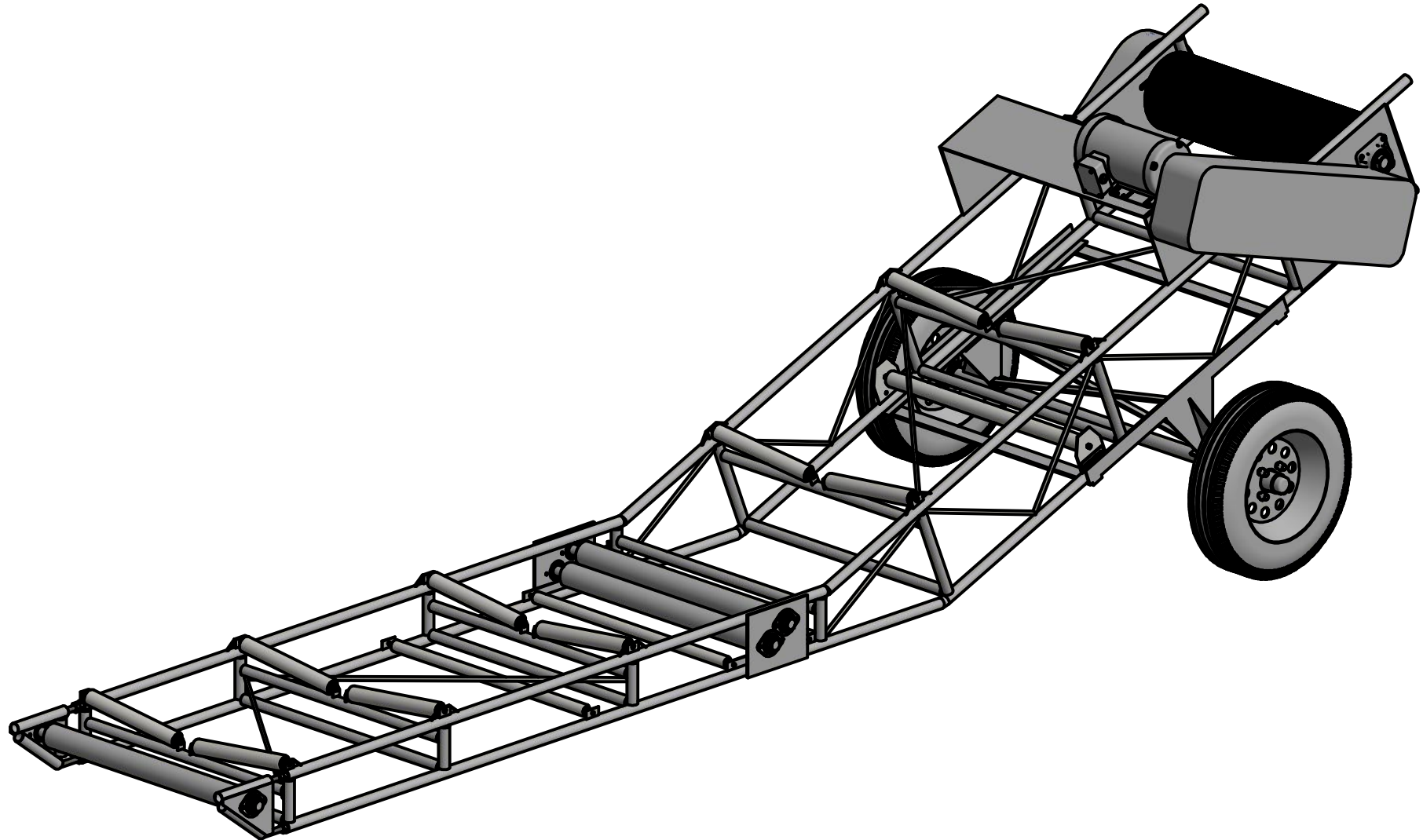

Multilift, Inc.

Denver, CO USA

www.ezliftconveyors.com

North American Toll Free: 1-800-821-9966

Denver Local: 303-733-5533

Model BDCU Driven End

Part#	Description
4-Bolt-flang 1.4375	4-Bolt Cast Iron Flange w/ 1-7/16" bearing
14H100JA	14-tooth timing belt Pulley w/ 1-1/8" bushing
60H100SF	60-tooth timing belt Pulley w/ 1" bushing
84DS- 30 x1.4375x40	Drive Shaft w/ 1-7/16" O.D. x 40"*
84DS- 36 x1.4375x48	Drive Shaft w/ 1-7/16" O.D. x 48"*
84SS- 30 x1x42	Secondary Drive Shaft w/ 1" O.D. x 42"*
84SS- 36 x1x48	Secondary Drive Shaft w/ 1" O.D. x 48"*
149	1" Bearing w/ 3-hole Triangular Flangettes
528- 30 -8	Drive Pulley w/ 1-7/16" bushing x 30"*
528- 36 -8	Drive Pulley w/ 1-7/16" bushing x 36"*
700H100	70" x 1" Timing Belt
EM3611T	3 hp 208-230/460V 3 phase TEFC motor

* bold number denotes conveyor belt width

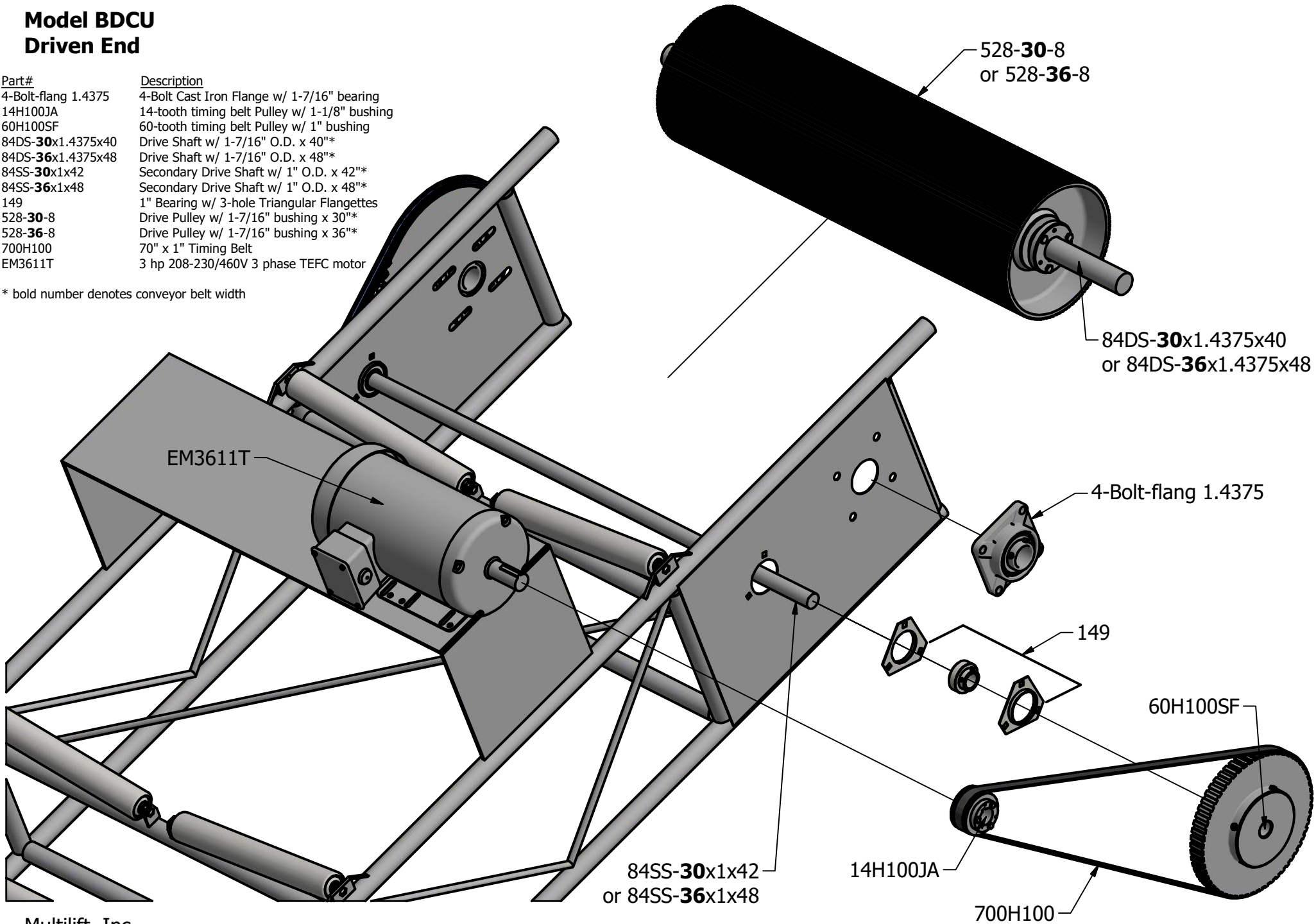

Model BDCU Driven End

Part#
 4-Bolt-flang 1.4375
 60 BS 09 1
 60 BS 45 1.4375
 84 60RC
 146BD 60RC
 149
 190BD timing
 199B
 199C
 399MBAhex

Description
 4-Bolt Cast Iron Flange w/ 1-7/16" bearing
 9-tooth Sprocket for #60 roller chain w/ 1" bore
 45-tooth Sprocket for #60 roller chain w/ 1-7/16" bore
 Section of #60 Roller Chain w/ connecting link
 Chain Guard for #60 roller chain
 1" Bearing w/ 3-hole Triangular Flangettes
 Timing belt Guard
 31" long idler return roller assembly
 37" long idler return roller assembly
 Mounting Bracket for return roller

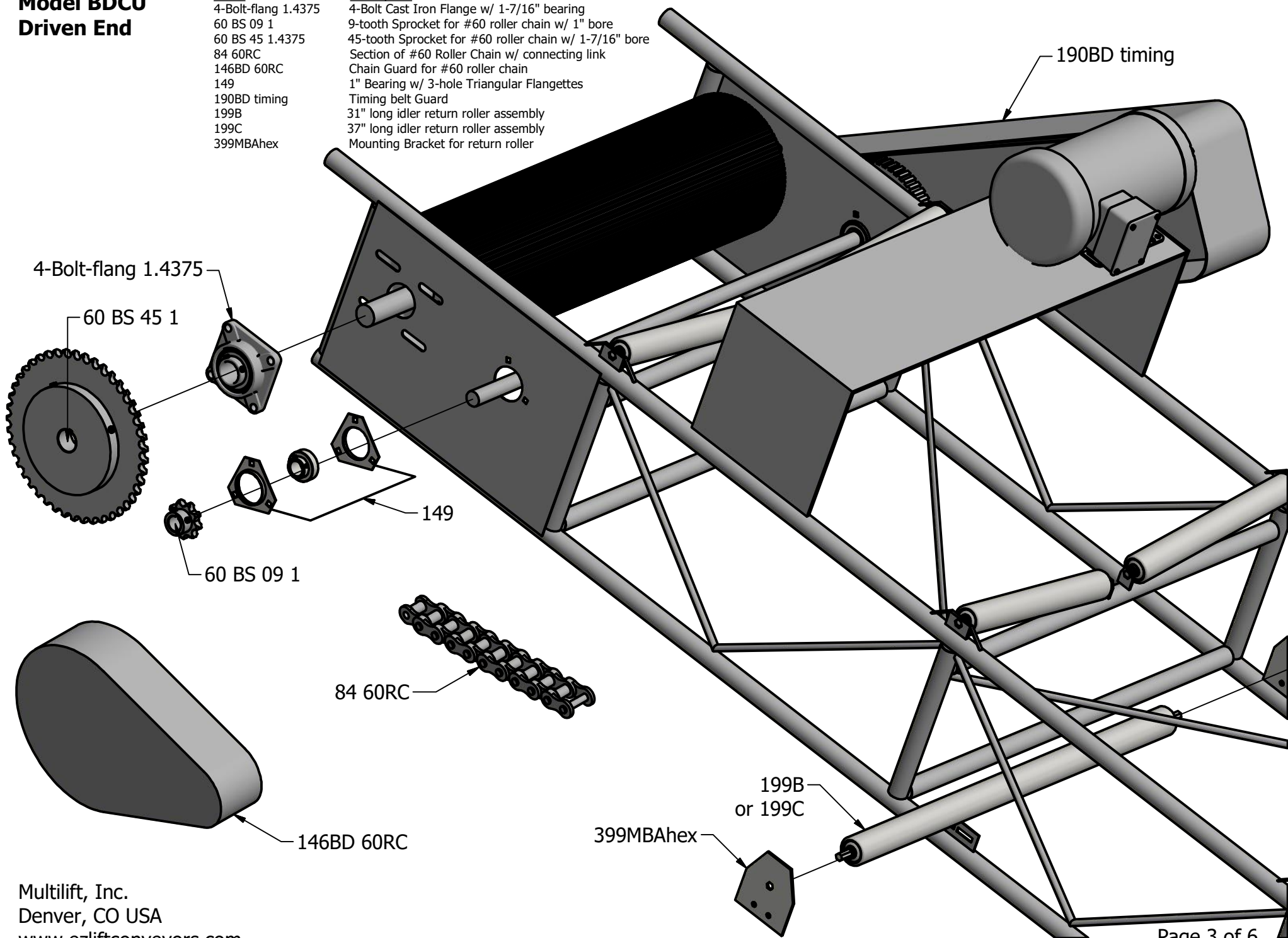

Model BDCU Serpentine Section

Part#	Description
31x1.375	31" long idler return roller assembly w/ 1-3/8" O.D.
37x1.375	37" long idler return roller assembly w/ 1-3/8" O.D.
149D	1-1/4" Bearing w/ 2-hole Oval Flangettes
84P- 30 JAx1.25	3" O.D. x 30" WF Tail & Serpentine Pulley with JA*
84P- 36 JAx1.25	3" O.D. x 36" WF Tail & Serpentine Pulley with JA*
84TS- 30 x1.25x37	1-1/4" O.D. x 37" long T&S shaft*
84TS- 36 x1.25x43	1-1/4" O.D. x 43" long T&S shaft*
198B	15" long idler top roller
199	19" long idler top roller

* bold number denotes conveyor belt width

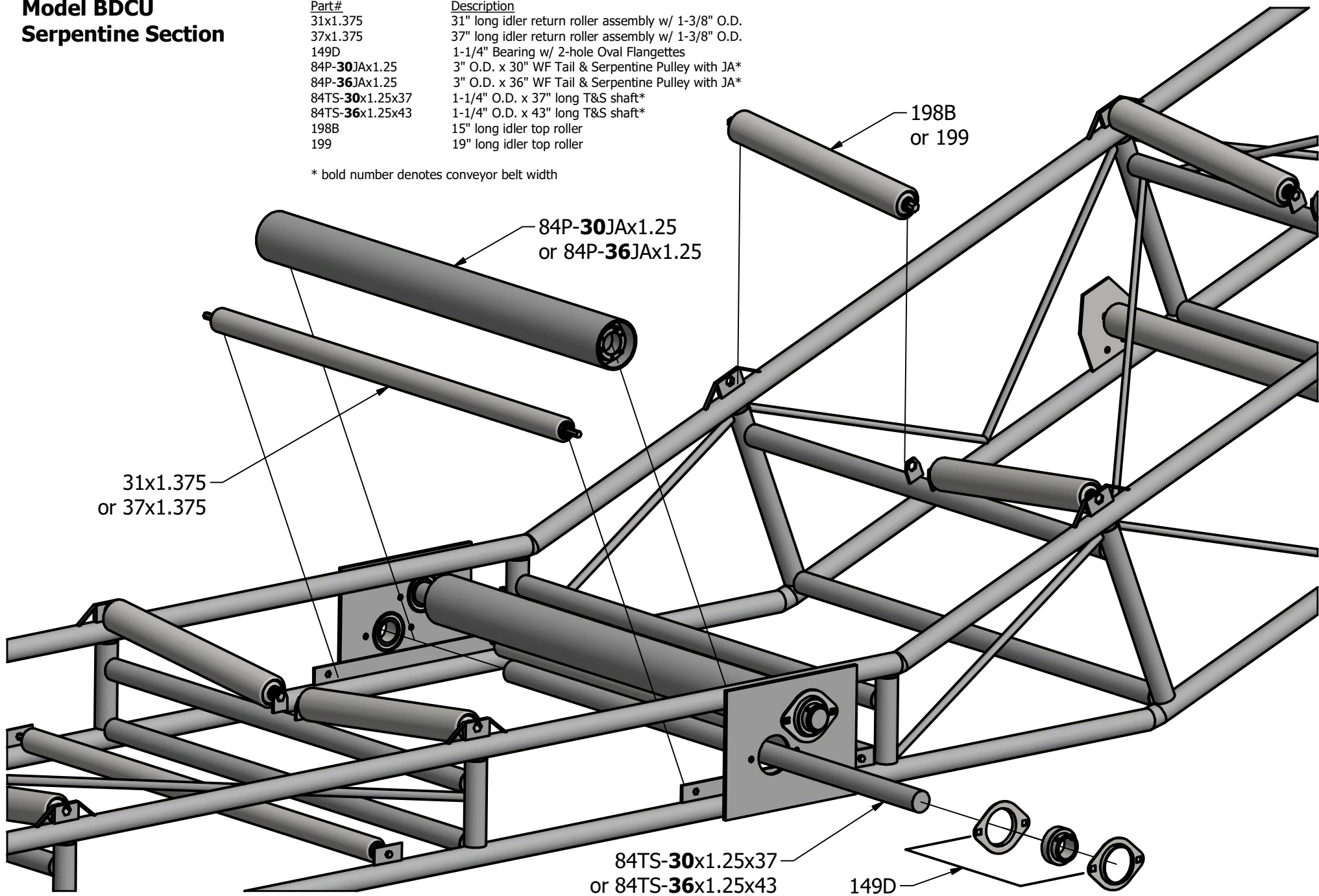

**Model BDCU
Idle End**

Part#	Description
149D	1-1/4" Bearing w/ 2-hole Oval Flangettes
84P- 30 JAx1.25	3" O.D. x 30" WF Tail & Serpentine Pulley with JA*
84P- 36 JAx1.25	3" O.D. x 36" WF Tail & Serpentine Pulley with JA*
84TS- 30 x1.25x37	1-1/4" O.D. x 37" long T&S shaft*
84TS- 36 x1.25x43	1-1/4" O.D. x 43" long T&S shaft*
84TULx1.25	Take-up frame w/ screw - LHS
84TURx1.25	Take-up frame w/ screw - RHS

* bold number denotes conveyor belt width

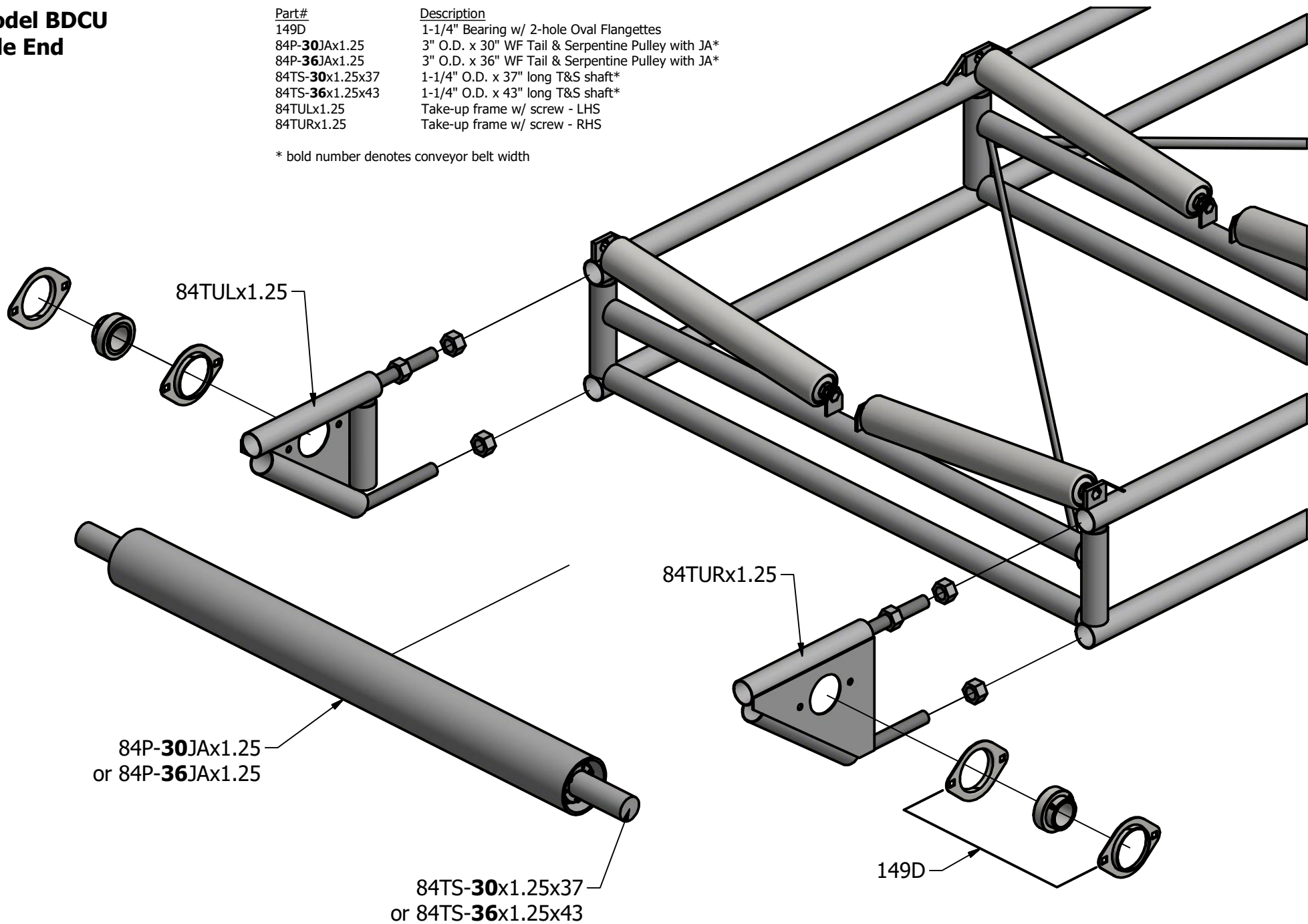

E-ZLIFT Bottom Dump Car Unloader BDCU (30" & 36" model)

Full Parts List Including Belting and Accessories

Part#	Description
4-Bolt-flang 1.4375	4-Bolt Cast Iron Flange w/ 1-7/16" bearing
14H100JA	14-tooth timing belt Pulley w/ 1-1/8" bushing
31x1.375	31" long idler return roller assembly w/ 1-3/8" O.D.
37x1.375	37" long idler return roller assembly w/ 1-3/8" O.D.
60 BS 09 1	9-tooth Sprocket for #60 roller chain w/ 1" bore
60 BS 45 1.4375	45-tooth Sprocket for #60 roller chain w/ 1-7/16" bore
60H100SF	60-tooth timing belt Pulley w/ 1" bushing
84 60RC	Section of #60 Roller Chain w/ connecting link
84DS- 30 x1.4375x40	Drive Shaft w/ 1-7/16" O.D. x 40"*
84DS- 36 x1.4375x48	Drive Shaft w/ 1-7/16" O.D. x 48"*
84P- 30 JAx1.25	3" O.D. x 30" WF Tail & Serpentine Pulley with JA*
84P- 36 JAx1.25	3" O.D. x 36" WF Tail & Serpentine Pulley with JA*
84SS- 30 x1x42	Secondary Drive Shaft w/ 1" O.D. x 42"*
84SS- 36 x1x48	Secondary Drive Shaft w/ 1" O.D. x 48"*
84TS- 30 x1.25x37	1-1/4" O.D. x 37" long T&S shaft*
84TS- 36 x1.25x43	1-1/4" O.D. x 43" long T&S shaft*
84TULx1.25	Take-up frame w/ screw - LHS (1-1/4" tubing)
84TURx1.25	Take-up frame w/ screw - RHS (1-1/4" tubing)
146BD 60RC	Chain Guard for #60 roller chain
149	1" Bearing w/ 3-hole Triangular Flangettes
149D	1-1/4" Bearing w/ 2-hole Oval Flangettes
198B	15" long idler top roller
190BD timing	Timing belt Guard
199	19" long idler top roller
199B	31" long idler return roller assembly
199C	37" long idler return roller assembly
399MBAhex	Mounting Bracket for return roller
528- 30 -8	Drive Pulley w/ 1-7/16" bushing x 30"*
528- 36 -8	Drive Pulley w/ 1-7/16" bushing x 36"*
700H100	700-tooth Timing Belt
EM3611T	3 hp 208-230/460V 3 phase TEFC motor

* bold number denotes conveyor belt width

Belt Parts and Accessories

Part#	Description
323- xx mcb	- xx wide, 3/16" high continuous mini-cleated belt*
323-86- 30	Dolly for 30" wide belt bottom dump car unloader
323-88- 36	Dolly for 36" wide belt bottom dump car unloader
325-M7- xx	Set of - xx long Screw Lacing w/ 7mm screws*
326- xx mcb	Set of #RS125 x - xx long Staple Lacing*, **

* **xx** denotes conveyor belt width (30" or 36")

** requires #326-4 tool for assembly

