

# E-ZLIFT Chain & Flight Conveyor C&F-050

## Parts List & Schematic

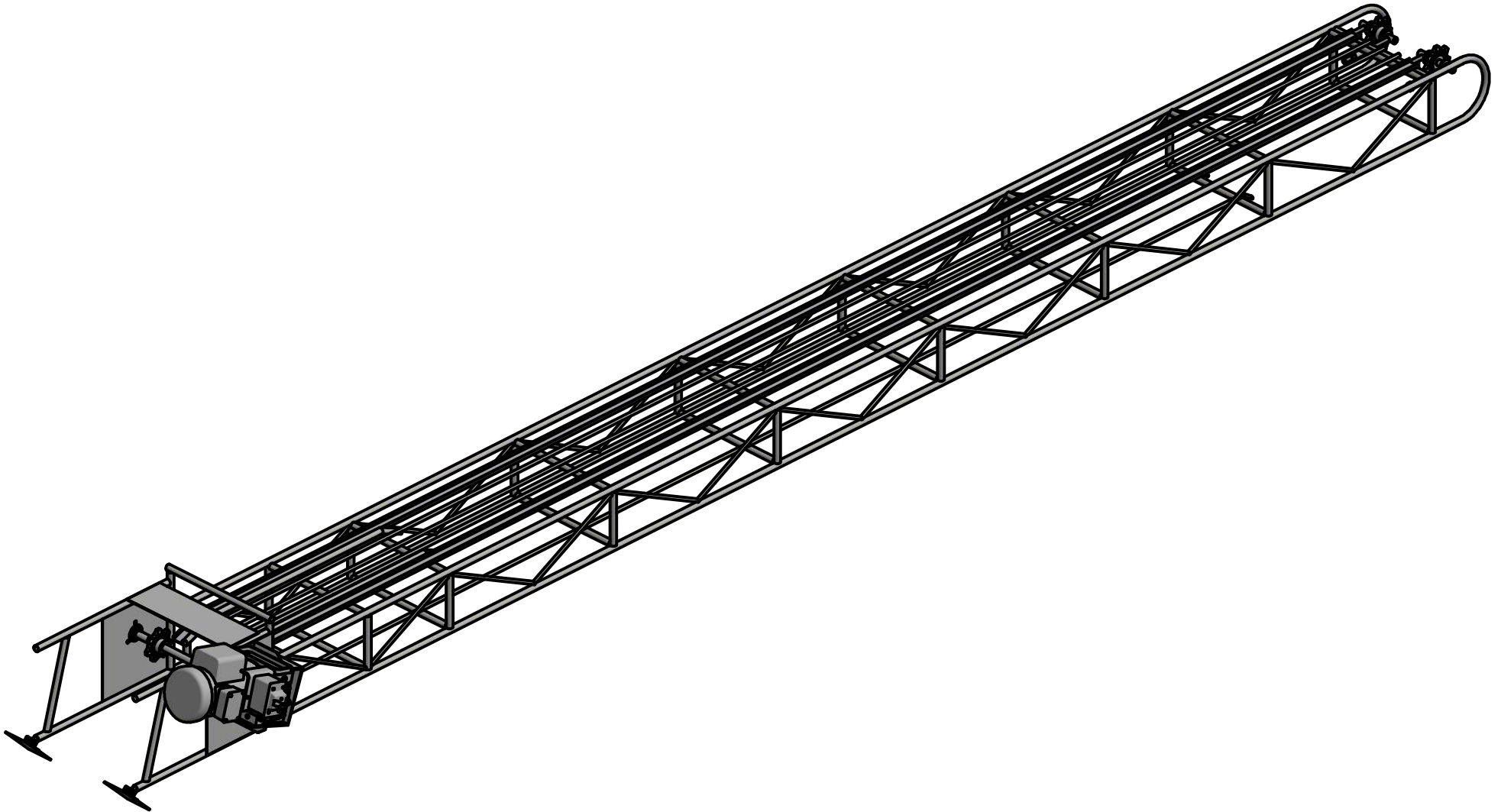

**Multilift, Inc.**

Denver, CO USA

[www.ezliftconveyors.com](http://www.ezliftconveyors.com)

North American Toll Free: 1-800-821-9966

Denver Local: 303-733-5533

**Model C&F-050  
Driven End**

Part#	Description
134DD	Drive Shaft w/ 1" O.D.
135A	7-tooth Sprocket w/ 1" bore for #55 chain
135A32W	8-tooth Sprocket w/ 1" bore for #32W chain
149	1" Bearing w/ 3-hole Triangular Flangettes
157	Handle for Motor/Reducer Assembly
162	Boot Mount for Size 50 Reducer
175A	Size 50 Reducer w/ 1" hollow bore
193	1 hp 115V 56C TEFC motor
193TR	Thermal Reset Button for Baldor 1 hp 3510M motor
194	1-1/2 hp 115V 56C TEFC motor
194TR	Thermal Reset Button for Baldor 1-1/2 hp 3514M motor
195B	Start/Stop switch
197	Rubber plated foot pad
Rubber cover	Rubber Cover for Thermal Reset Button

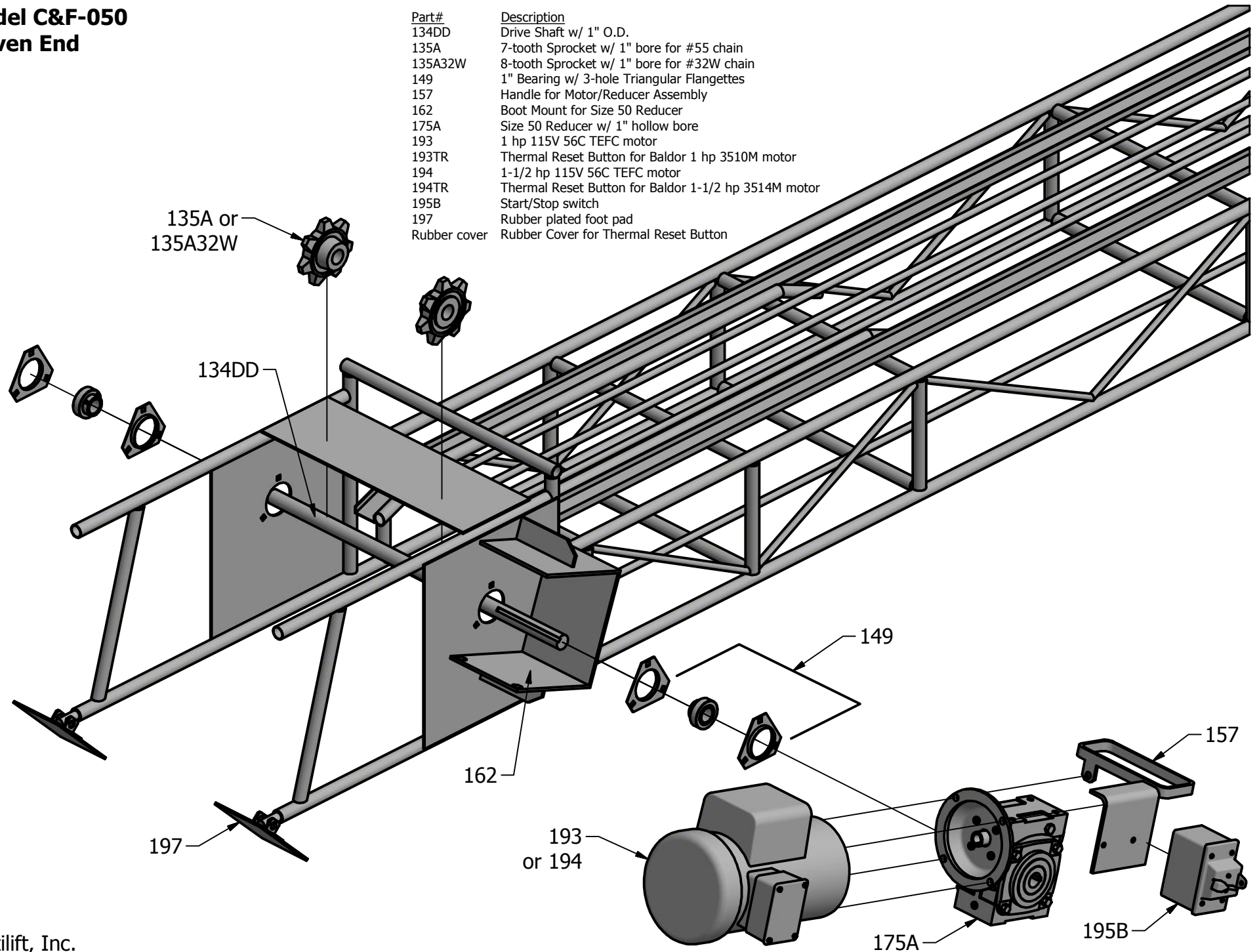

# Model C&F-050

## Idle End and Flight Assembly

Part#	Description
101-32W	Flight assembly for #32W chain
101-55	Flight assembly for #55 chain
112-32W	#32W chain / ft.
112-55	#55 chain / ft.
135B	7-tooth Sprocket w/ 7/8" bore for #55 chain*
135B32W	8-tooth Sprocket w/ 7/8" bore for #32W chain*
136	(2) All-thread adjustment rods**
137	5/8" Shaft for idler sprocket

Complete Chain with Flights Assemblies	
Part#	Description
117-32W	16' conveyor w/ #32W chain
117-55	16' conveyor w/ #55 chain
118-32W	21' conveyor w/ #32W chain
118-55	21' conveyor w/ #55 chain
120-32W	26' conveyor w/ #32W chain
120-55	26' conveyor w/ #55 chain
121-55	31' conveyor w/ #55 chain

\* includes 5/8" I.D. bushing  
 \*\* includes (4) nuts, (2) washers, and (1) cotter pin

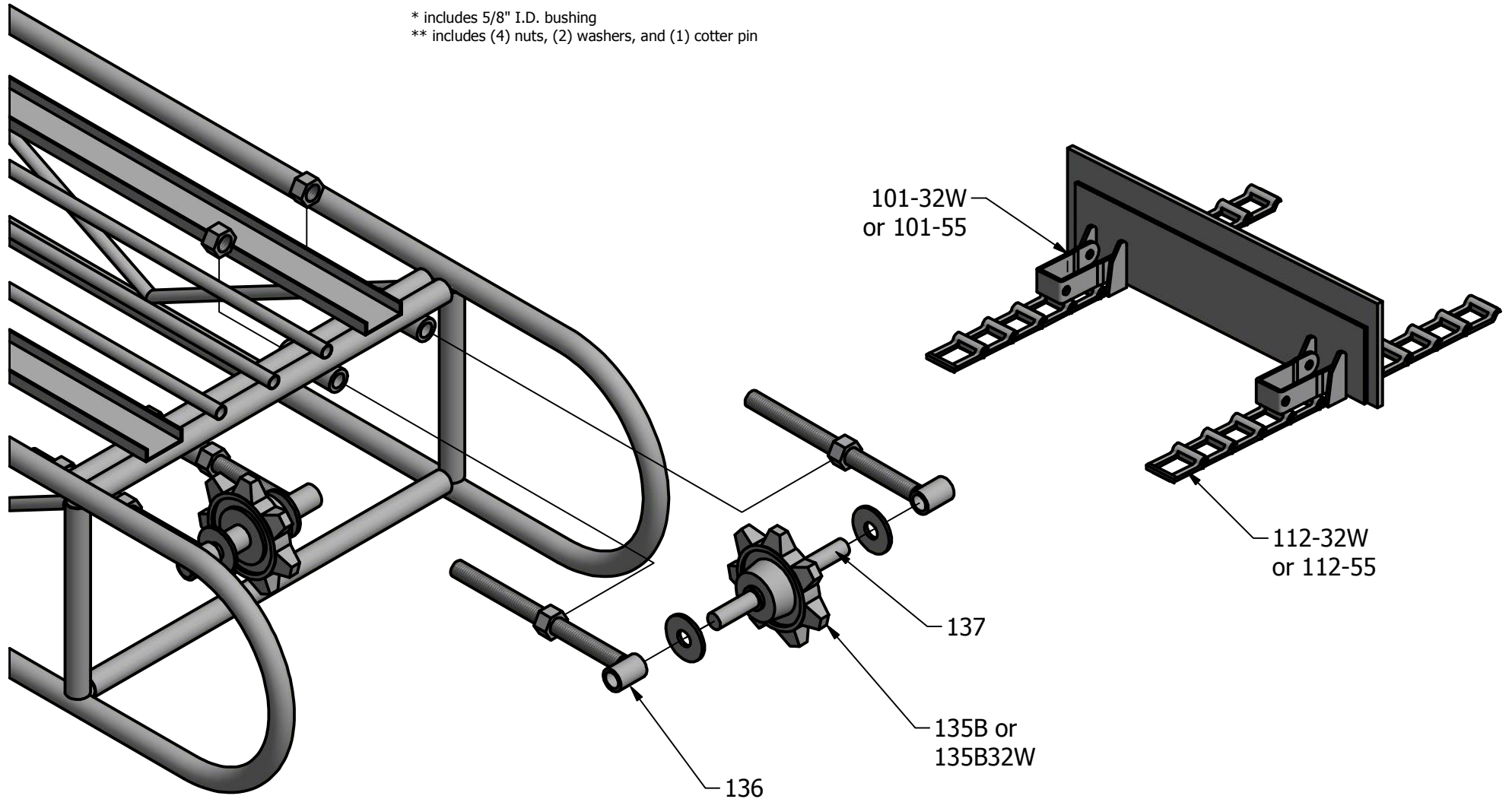

# E-ZLIFT Chain & Flight Conveyor C&F-050

## Full Parts List

Part#	Description
134DD	Drive Shaft w/ 1" O.D.
135A	7-tooth Sprocket w/ 1" bore for #55 chain
135A32W	8-tooth Sprocket w/ 1" bore for #32W chain
149	1" Bearing w/ 3-hole Triangular Flangettes
157	Handle for Motor/Reducer Assembly
162	Boot Mount for Size 50 Reducer
175A	Size 50 Reducer w/ 1" hollow bore
193	1 hp 115V 56C TEFC motor
193TR	Thermal Reset Button for Baldor 1 hp 3510M motor
194	1-1/2 hp 115V 56C TEFC motor
194TR	Thermal Reset Button for Baldor 1-1/2 hp 3514M motor
195B	Start/Stop switch
197	Rubber plated foot pad
Rubber cover	Rubber Cover for Thermal Reset Button

Part#	Description
101-32W	Flight assembly for #32W chain
101-55	Flight assembly for #55 chain
112-32W	#32W chain / ft.
112-55	#55 chain / ft.
135B	7-tooth Sprocket w/ 7/8" bore for #55 chain*
135B32W	8-tooth Sprocket w/ 7/8" bore for #32W chain*
136	(2) All-thread adjustment rods**
137	5/8" Shaft for idler sprocket

\* includes 5/8" I.D. bushing  
 \*\* includes (4) nuts, (2) washers, and (1) cotter pin

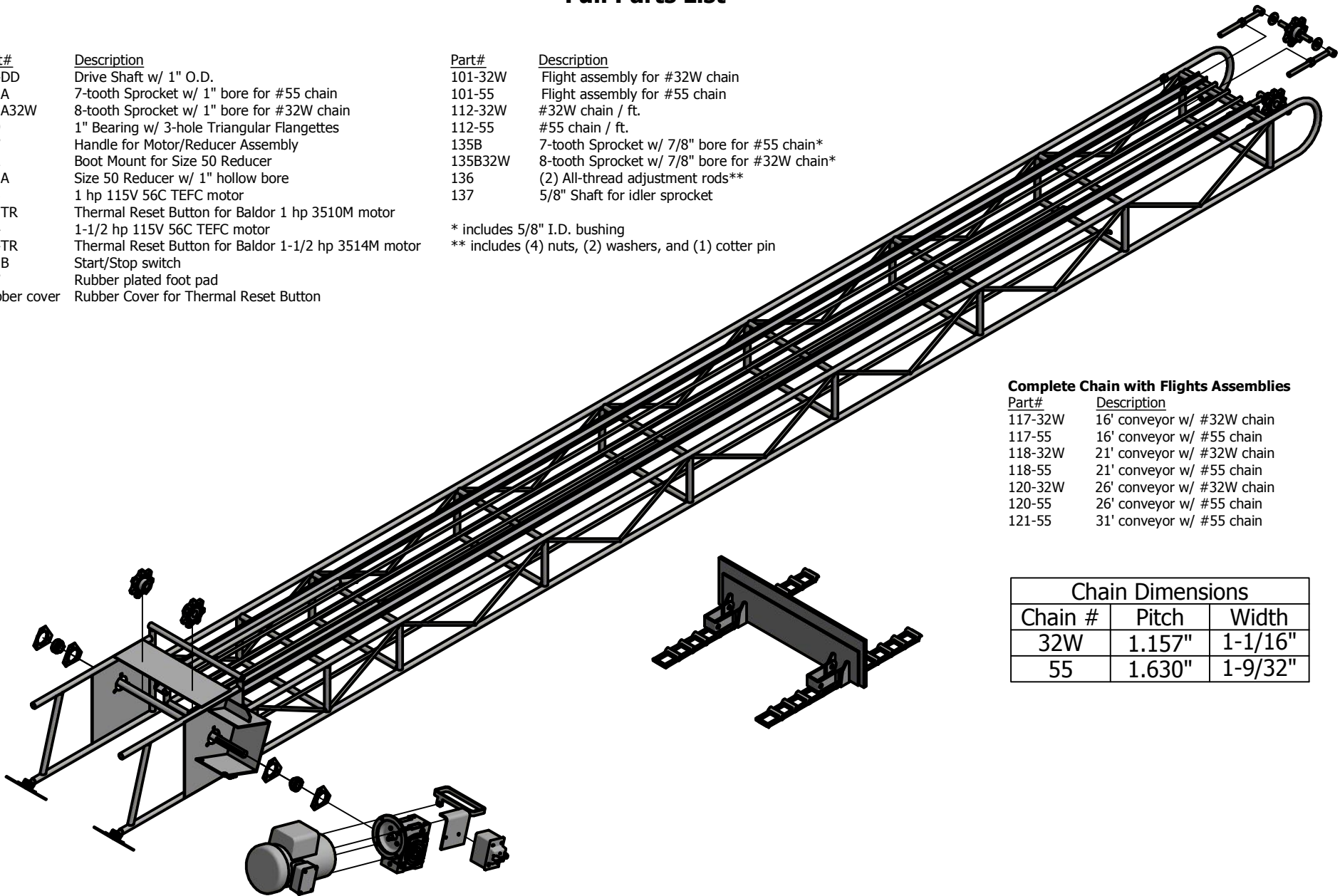

### Complete Chain with Flights Assemblies

Part#	Description
117-32W	16' conveyor w/ #32W chain
117-55	16' conveyor w/ #55 chain
118-32W	21' conveyor w/ #32W chain
118-55	21' conveyor w/ #55 chain
120-32W	26' conveyor w/ #32W chain
120-55	26' conveyor w/ #55 chain
121-55	31' conveyor w/ #55 chain

Chain Dimensions		
Chain #	Pitch	Width
32W	1.157"	1-1/16"
55	1.630"	1-9/32"