

# E-ZLIFT E-ZMite Sidepan Conveyor EZ-050S

## with 10" Wide Mini-Cleated Belt

### Parts List & Schematic

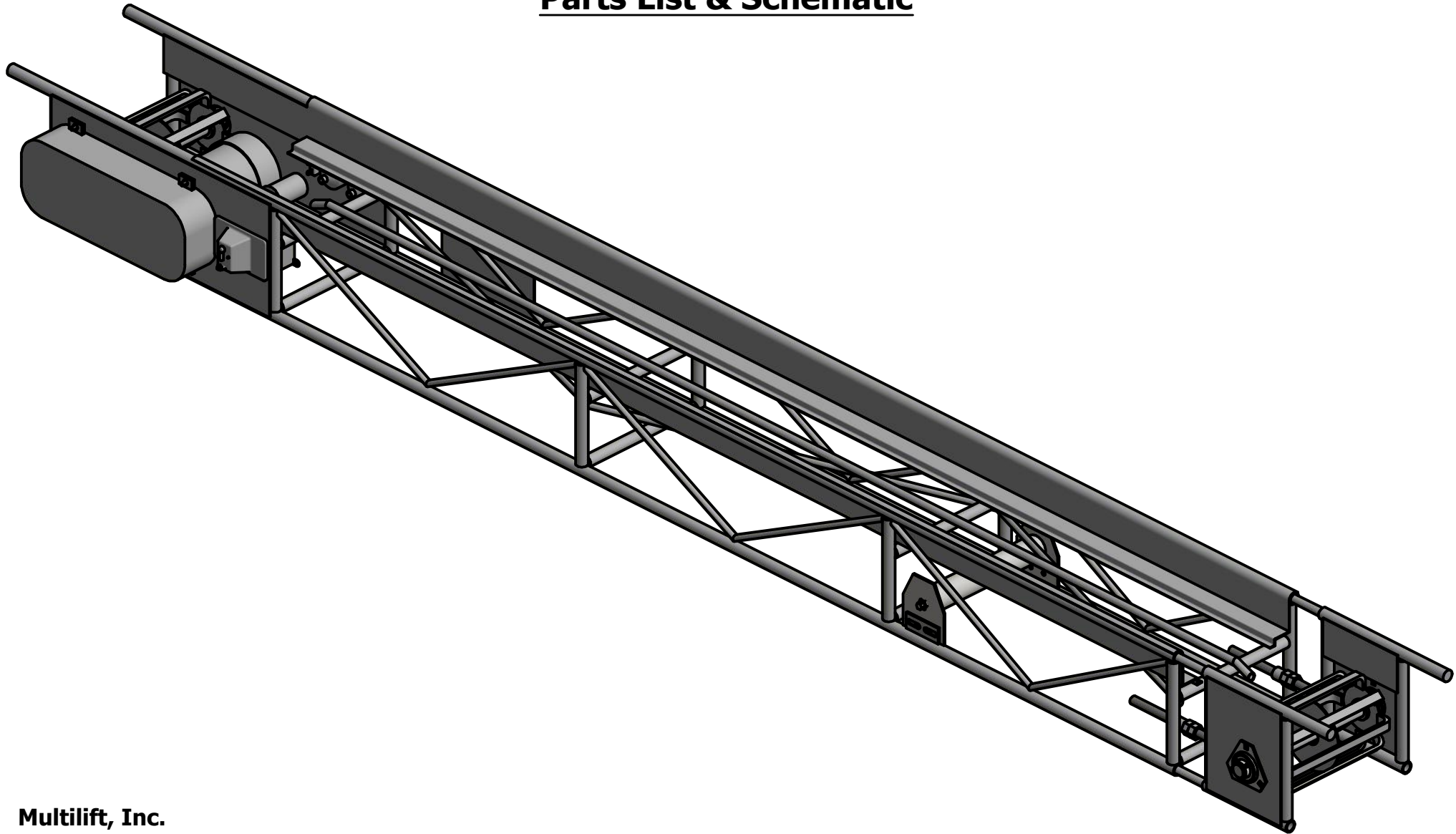

**Multilift, Inc.**

Denver, CO USA

[www.ezliftconveyors.com](http://www.ezliftconveyors.com)

North American Toll Free: 1-800-821-9966

Denver Local: 303-733-5533

**Model EZ-050S  
Driven End**

Part#	Description
149	1" Bearing w/ 3-hole Triangular Flangettes
195BHRLUW	Start/Stop switch
400	1/4 hp 115V gearmotor
428	Drive Pulley w/ 1" bore
430	Drive Shaft w/ 1" O.D.
435	Chain guard
440	12-tooth Sprocket w/ 3/4" bore for #40 chain
442	20-tooth Sprocket w/ 1" bore for #40 chain
445	Section of #40 roller chain*

\* 49 pitches + connecting link

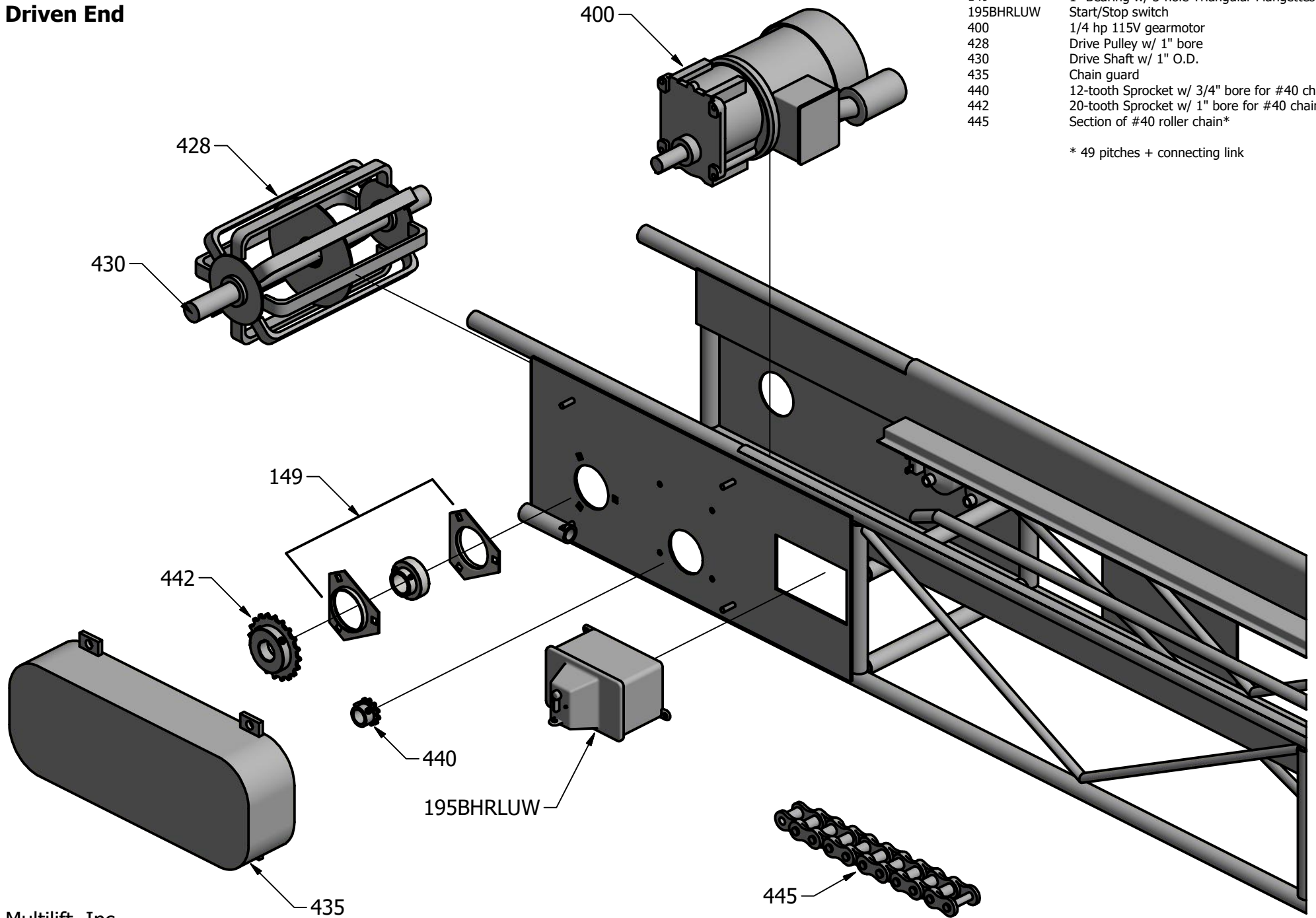

**Model EZ-050S**  
**Driven End**

Part#	Description
149A	1" Bearing w/ Rectangle/Oval Flangettes
202	2" Side Pan x 8 ft. long
410	Electrical Inlet (male)
412	Electrical Outlet (female)
414	Thermal Overload Reset Button

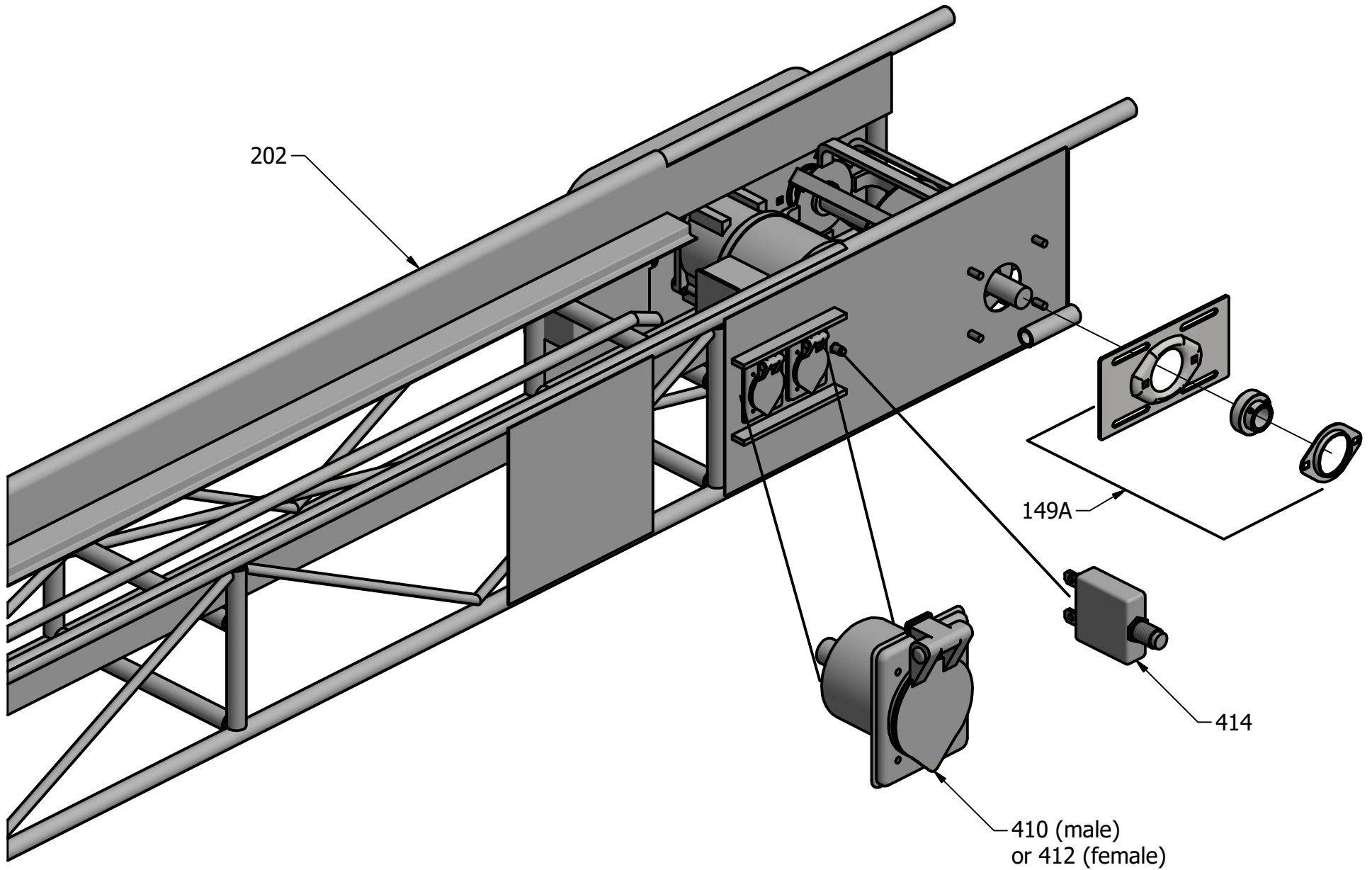

**Model EZ-050S**  
**Idle End**

Part#	Description
149	1" Bearing w/ 3-hole Triangular Flangettes
198A	11" long return roller assembly
399MBAhex	Mounting bracket for return roller
399MBslot	Return wheel/roller weld-on bracket
415	Take-up frame w/ adjustment screw - RHS
417	Take-up frame w/ adjustment screw - LHS
429	Tail Pulley w/ 1" bore
432	Tail Shaft w/ 1" O.D.

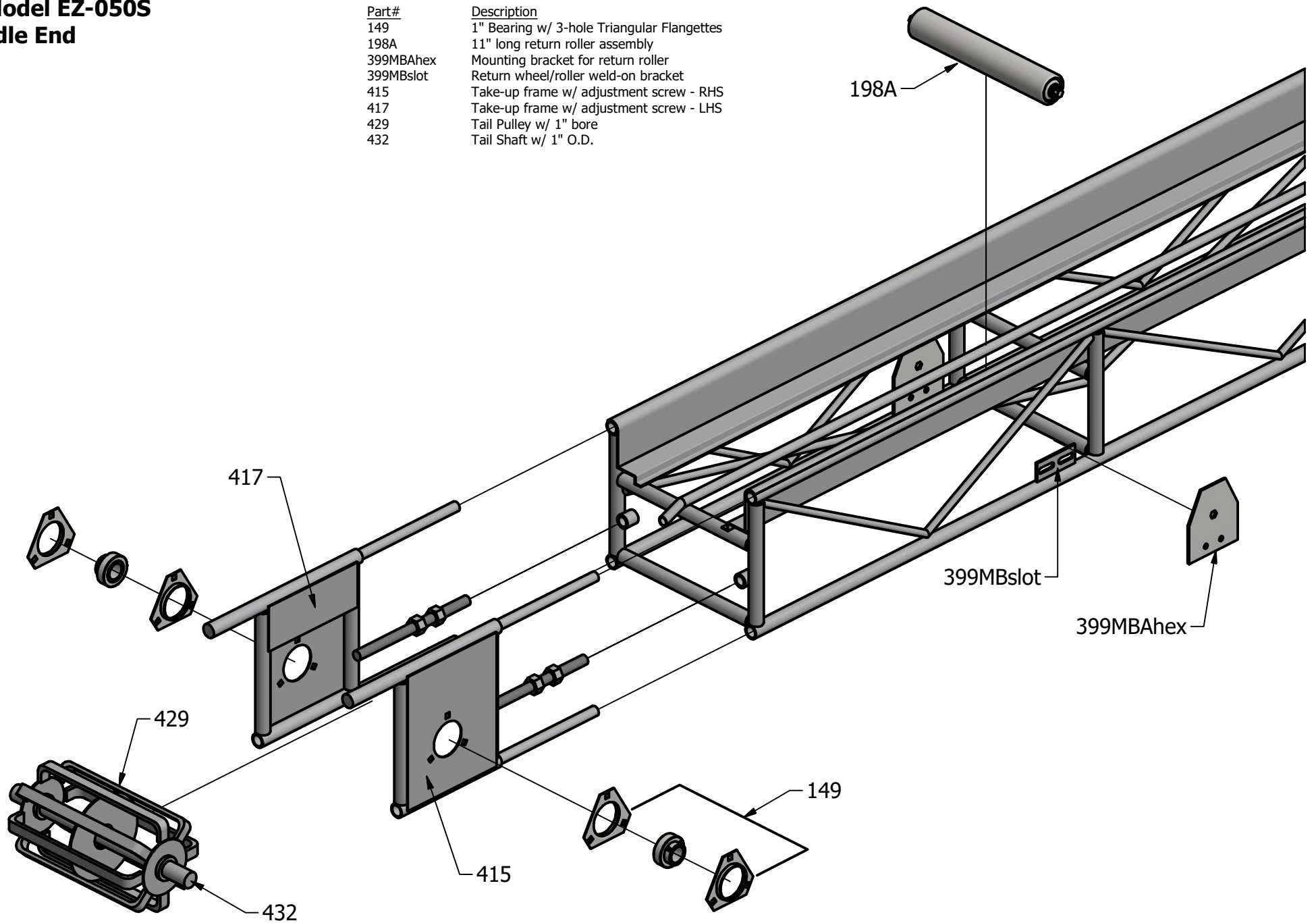

# E-ZLIFT E-ZMite Sidepan Conveyor EZ-050S

## Full Parts List Including Belting and Lacing

Part#	Description
149	1" Bearing w/ 3-hole Triangular Flangettes
195BHRLUW	Start/Stop switch
198A	11" long return roller assembly
400	1/4 hp 115V gearmotor
435	Chain guard
440	12-tooth Sprocket w/ 3/4" bore for #40 chain
442	20-tooth Sprocket w/ 1" bore for #40 chain
445	Section of #40 roller chain*
468	Drive Pulley w/ 1" bore
470	Drive Shaft w/ 1" O.D.

\* 49 pitches + connecting link

Part#	Description
149A	1" Bearing w/ Rectangle/Oval Flangettes
202	2" Side Pan x 8 ft. long
410	Electrical Inlet (male)
412	Electrical Outlet (female)
414	Thermal Overload Reset Button
198A	11" long steel idler top roller
399MBAhex	Mounting bracket for return roller
399MBSlot	Return wheel/roller weld-on bracket
415	Take-up frame w/ adjustment screw - RHS
417	Take-up frame w/ adjustment screw - LHS
429	Tail Pulley w/ 1" bore
432	Tail Shaft w/ 1" O.D.

### Complete Mini-Cleated Belt Assemblies

Part#	Description
405-10	10 ft. conveyor
405-12	12 ft. conveyor

### Belt Parts and Accessories

Part#	Description
152EZM	Dolly for E-ZMite
152EZMT	Weld-on tube receptor
231	Wheel for E-ZMite dolly
323-10mcb	10" wide 2 ply 150 # 1/16" x B mini-cleated belting / ft.
325-M7-10	Set of 10" long Screw Lacing w/ 7mm screws
426	Set of #RS125 x 10" long Staple Lacing*

\* requires #326-4 tool for assembly

