

E-ZLIFT E-ZMite Troughing Conveyor EZ-T050

with 14" Wide Cleated Belt

Parts List & Schematic

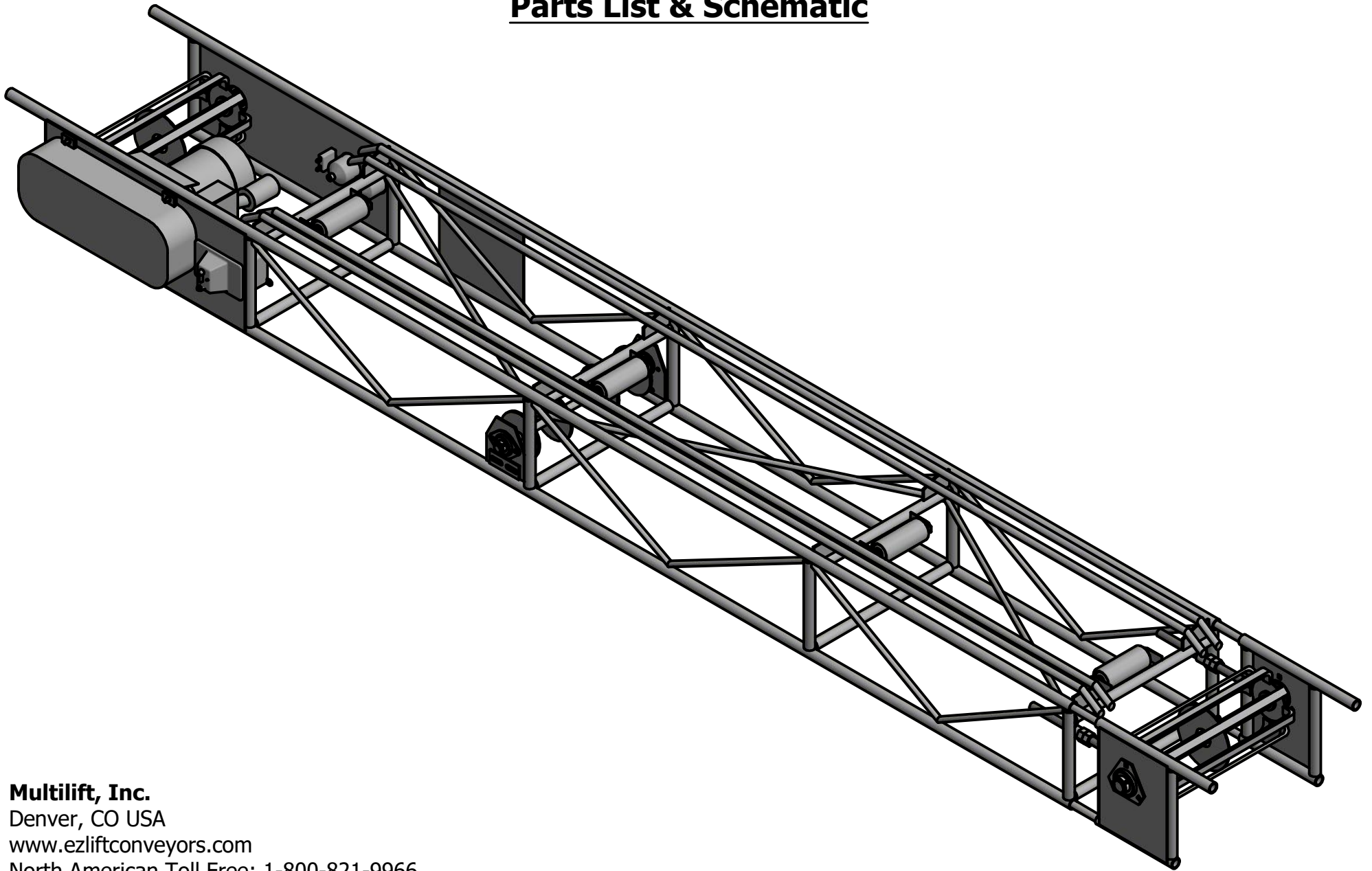

Multilift, Inc.

Denver, CO USA

www.ezliftconveyors.com

North American Toll Free: 1-800-821-9966

Denver Local: 303-733-5533

**Model EZ-T050
Driven End**

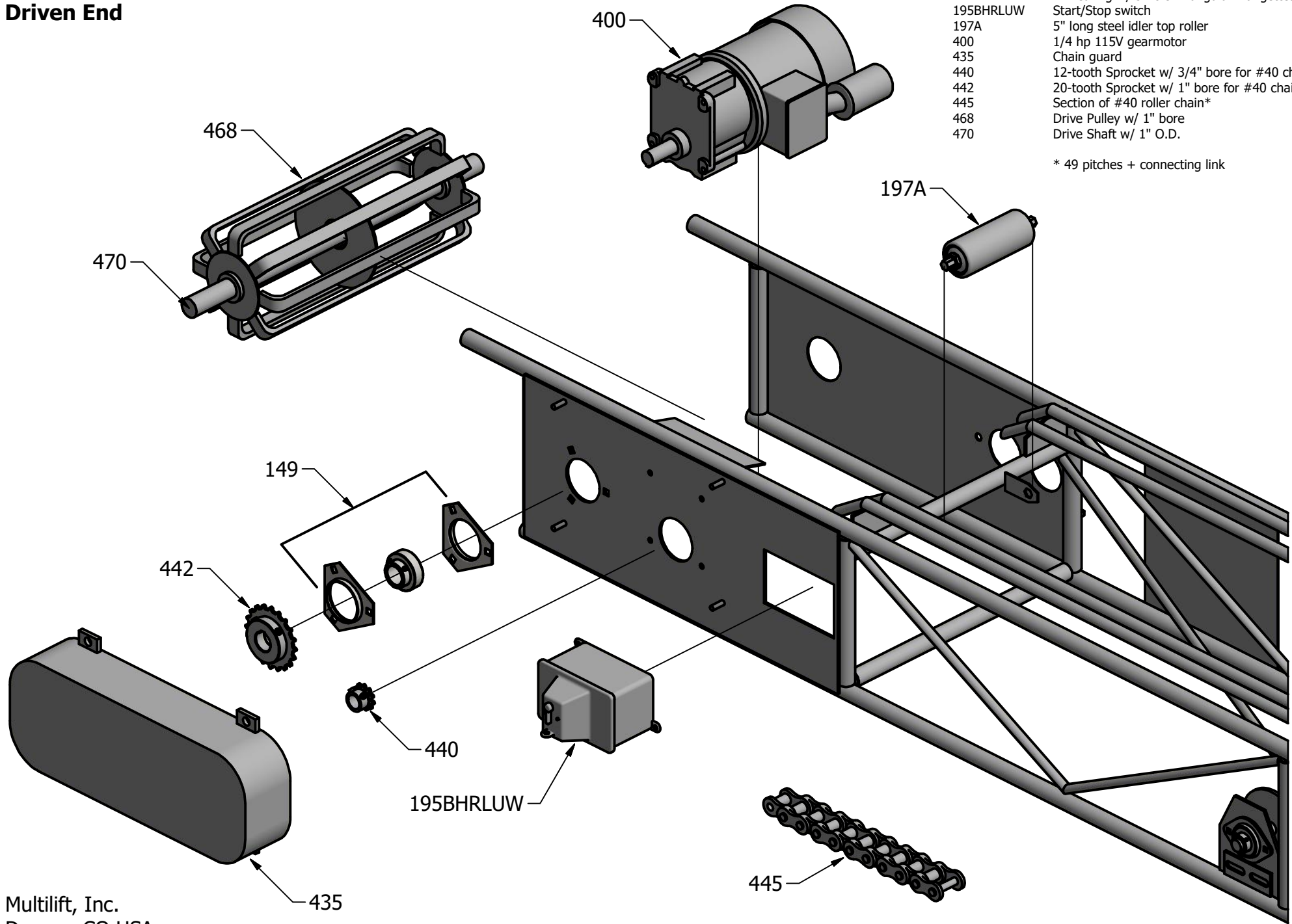

Part#	Description
149	1" Bearing w/ 3-hole Triangular Flangettes
195BHRLUW	Start/Stop switch
197A	5" long steel idler top roller
400	1/4 hp 115V gearmotor
435	Chain guard
440	12-tooth Sprocket w/ 3/4" bore for #40 chain
442	20-tooth Sprocket w/ 1" bore for #40 chain
445	Section of #40 roller chain*
468	Drive Pulley w/ 1" bore
470	Drive Shaft w/ 1" O.D.

* 49 pitches + connecting link

**Model EZ-T050
Driven End**

Part#	Description
149A	1" Bearing w/ Rectangle/Oval Flangettes
153A	5/8" Bearing w/ 2-hole Oval Flangettes
399MB	Mounting bracket for return wheels
399MBslot	Return wheel/roller weld-on bracket
410	Electrical Inlet (male)
412	Electrical Outlet (female)
414	Thermal Overload Reset Button
480	Return Wheels w/ 5/8" shaft

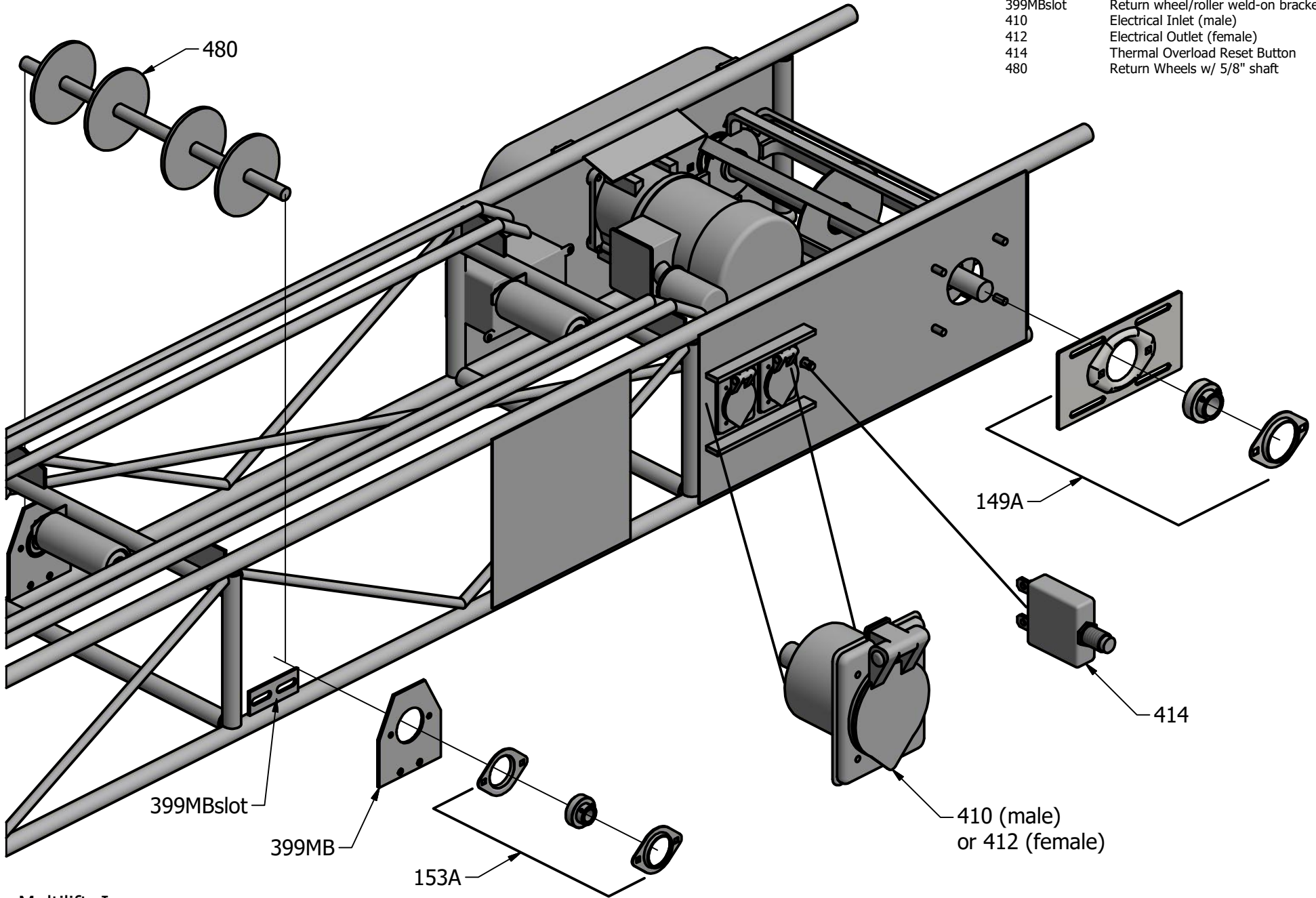

Model EZ-T050
Idle End

Part#	Description
149	1" Bearing w/ 3-hole Triangular Flangettes
469	Tail Pulley w/ 1" bore
472	Tail Shaft w/ 1" O.D.
485	Take-up frame w/ adjustment screw - RHS
487	Take-up frame w/ adjustment screw - LHS

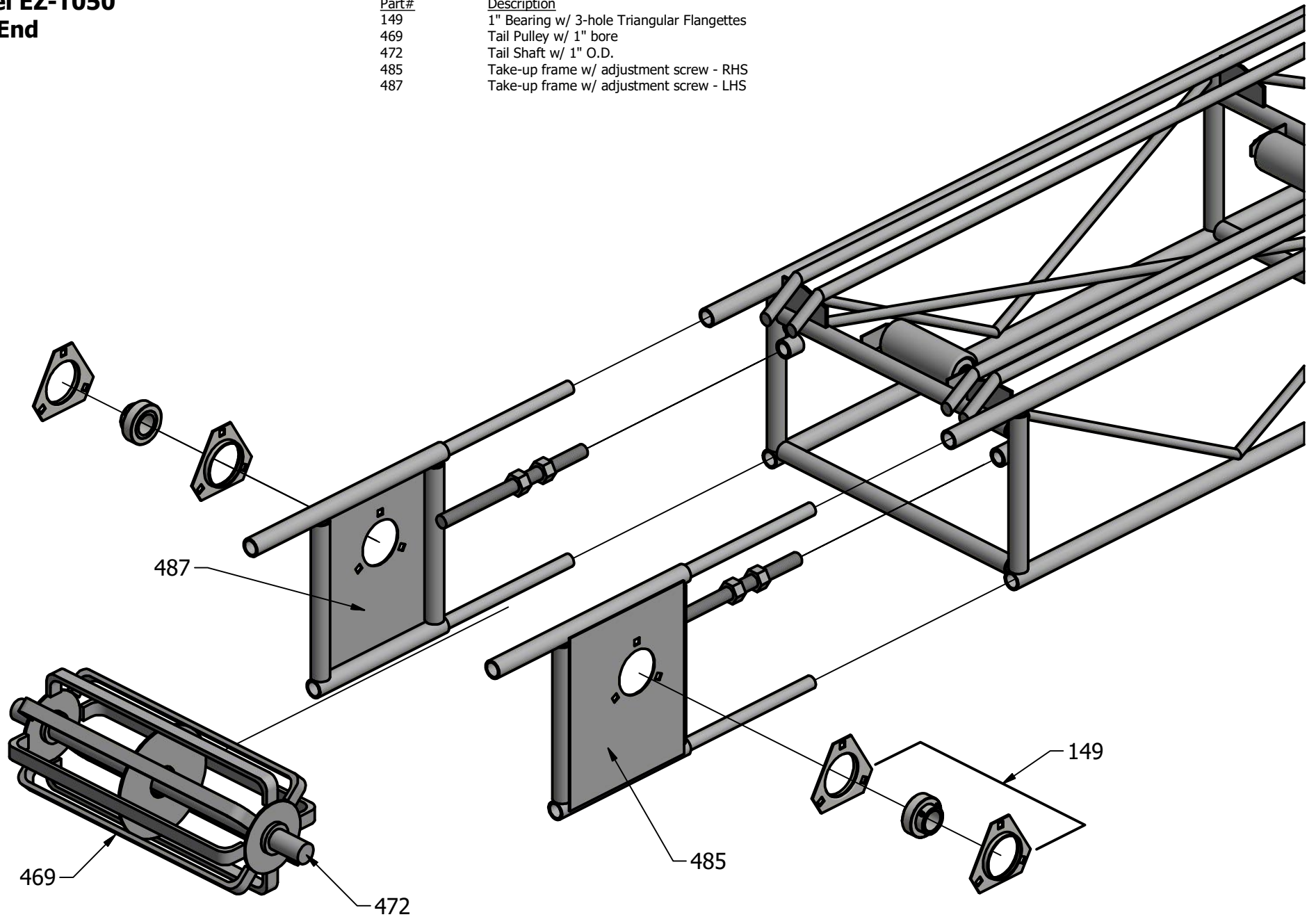

E-ZLIFT E-ZMite Troughing Conveyor EZ-T050

Full Parts List Including Belting and Lacing

Part#	Description
149	1" Bearing w/ 3-hole Triangular Flangettes
195BHRLUW	Start/Stop switch
400	1/4 hp 115V gearmotor
428	Drive Pulley w/ 1" bore
430	Drive Shaft w/ 1" O.D.
435	Chain guard
440	12-tooth Sprocket w/ 3/4" bore for #40 chain
442	20-tooth Sprocket w/ 1" bore for #40 chain
445	Section of #40 roller chain*

* 49 pitches + connecting link

Part#	Description
149A	1" Bearing w/ Rectangle/Oval Flangettes
153A	5/8" Bearing w/ 2-hole Oval Flangettes
399MB	Mounting bracket for return wheels
399MBslot	Return wheel/roller weld-on bracket
410	Electrical Inlet (male)
412	Electrical Outlet (female)
414	Thermal Overload Reset Button
480	Return Wheels w/ 5/8" shaft
469	Tail Pulley w/ 1" bore
472	Tail Shaft w/ 1" O.D.
485	Take-up frame w/ adjustment screw - RHS
487	Take-up frame w/ adjustment screw - LHS

Complete Belt Assemblies

Part#	Description
455	10 ft. conveyor w/ 1-1/4" cleats
455mcb	10 ft. conveyor w/ mini-cleated belt
456	12 ft. conveyor w/ 1-1/4" cleats
455mcb	12 ft. conveyor w/ mini-cleated belt

Belt Parts and Accessories

Part#	Description
152EZM	Dolly for E-ZMite
152EZMT	Weld-on tube receptor
231	Wheel for E-ZMite dolly
307 1-1/4 14	Set of (3) 1-1/4" bolt on Cleats for 14" wide belt
223-14S	14" wide 2 ply 1/16" x FS belting / ft.
323-14mcb	10" wide 2 ply 150 # 1/16" x B mini-cleated belting / ft.
325-M10-14	Set of 14" long Screw Lacing w/ 10mm screws
325-M7-14	Set of 14" long Screw Lacing w/ 7mm screws
326-14	Set of #RS187 x 14" long Staple Lacing for smooth belt*
326-14mcb	Set of #RS125 x 14" long Staple Lacing for mcb*

* requires #326-4 tool for assembly

